

## BSI Bombas Submersíveis de Furo | Submersible Well Pumps

### ▶ APLICAÇÕES

Sistemas de rega sob pressão  
Sistemas hidropressores  
Abastecimento de água público e doméstico  
Aplicações industriais  
Redução dos níveis freáticos

### ▶ MATERIAIS DE CONSTRUÇÃO

Corpo da bomba: Aço inoxidável AISI 304  
Impulsor: Aço inoxidável AISI 304  
Veio: Aço inoxidável AISI 304

### ▶ LIMITES DE UTILIZAÇÃO

Caudal máximo: até 240 m<sup>3</sup>/h  
Altura manométrica: até 400 m  
Temperatura máxima da água: +35°C  
PH do líquido: 6,5 a 8,5  
Instalação: Vertical ou horizontal<sup>(1)</sup>  
Máxima concentração de areia: 25 g/m<sup>3</sup>

### ▶ CARACTERÍSTICAS DO MOTOR

Tipo: Submersível  
Tensão: 1x230V ou 3x400V  
Classe de isolamento: F  
Classe de proteção: IP68  
Rotação: 2850 r.p.m.

### ▶ APPLICATIONS

Pressurized irrigation systems  
Booster set systems  
Public and domestic water supply  
Industrial applications  
Lowering of groundwater levels

### ▶ CONSTRUCTION MATERIALS

Pump body: AISI 304 stainless steel  
Impeller: AISI 304 stainless steel  
Shaft: AISI 304 stainless steel

### ▶ WORKING LIMITS

Maximum flow rate: up to 240 m<sup>3</sup>/h  
Manometric head: up to 400 m  
Maximum liquid temperature: +35°C  
PH of the liquid: 6,5 to 8,5  
Installation: vertical or horizontal<sup>(1)</sup>  
Maximum sand content: 25 g/m<sup>3</sup>

### ▶ MOTOR SPECIFICATIONS

Type: Submersible  
Voltage: 1x230V or 3x400V  
Insulation class: F  
Protection class: IP68  
Rotation: 2850 r.p.m.

<sup>(1)</sup> Contacte os nossos Serviços Técnicos para seleção e cotações

<sup>(1)</sup> Please contact our Technical Services for selection and quotations



A **Série BSI** é constituída por bombas centrifugas, multi-celulares, submersíveis de 4", 6", 8" e 10", destinadas à captação de águas subterrâneas. Com excelente resistência à corrosão, dada a sua construção integralmente em aço inox.

The **BSI series** consists of multistage, centrifugal, submersible pumps, of 4", 6", 8" and 10", for deep well underground water supply, with excellent resistance against corrosion due to its fully stainless steel construction.

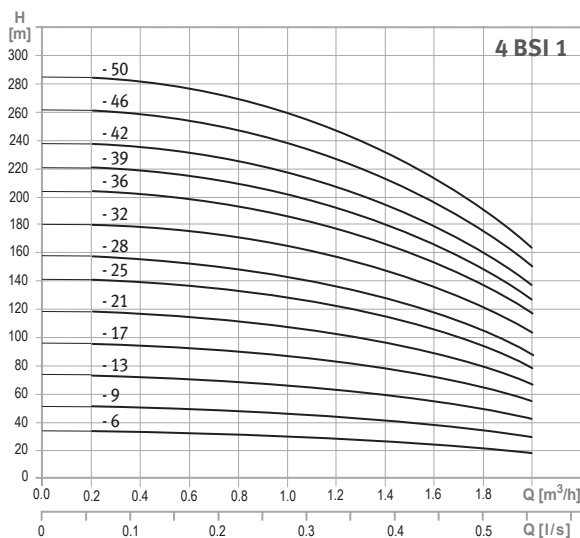

MODELO   MODEL		POTÊNCIA POWER (kW)	DIMENSÕES   DIMENSIONS (mm)			PESO WEIGHT (Kg)
1 ~	3 ~		A	B	C	
4BSI M1-6	4BSI 1-6	0,37	667	370	297	12
4BSI M1-9	4BSI 1-9	0,37	730	370	360	13
4BSI M1-13	4BSI 1-13	0,55	824	380	444	15
4BSI M1-17	4BSI 1-17	0,75	928	400	528	17
4BSI M1-21	4BSI 1-21	1,1	1052	440	612	19
4BSI M1-25	4BSI 1-25	1,1	1136	440	696	20
4BSI M1-28	4BSI 1-28	1,5	1229	470	759	23
4BSI M1-32	4BSI 1-32	1,5	1313	470	843	24
4BSI M1-36	4BSI 1-36	1,5	1397	470	927	25
-	4BSI 1-39	2,2	1500	510	990	29
-	4BSI 1-42	2,2	1563	510	1053	30
-	4BSI 1-46	2,2	1647	510	1137	31
-	4BSI 1-50	2,2	1731	510	1221	32

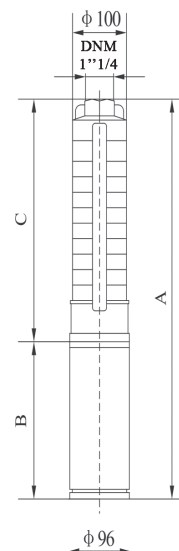

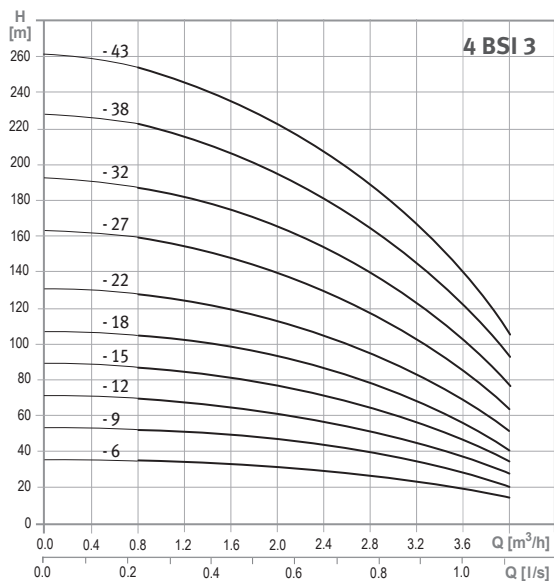
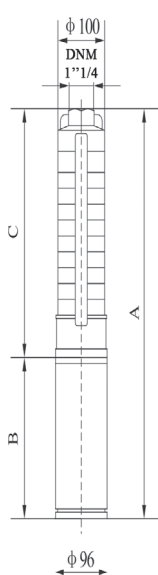

MODELO   MODEL		POTÊNCIA POWER (kW)	DIMENSÕES   DIMENSIONS (mm)			PESO WEIGHT (kg)
1 ~	3 ~		A	B	C	
4BSI M3-6	4BSI 3-6	0,37	667	370	297	12
4BSI M3-9	4BSI 3-9	0,55	740	380	360	13
4BSI M3-12	4BSI 3-12	0,75	823	400	423	16
4BSI M3-15	4BSI 3-15	1,1	926	440	489	18
4BSI M3-18	4BSI 3-18	1,1	999	440	549	19
4BSI M3-22	4BSI 3-22	1,5	1103	470	633	22
4BSI M3-27	4BSI 3-27	2,2	1248	510	738	27
4BSI M3-32	4BSI 3-32	2,2	1353	510	843	28
-	4BSI 3-38	3,0	1589	620	969	31
-	4BSI 3-43	3,0	1694	620	1074	32

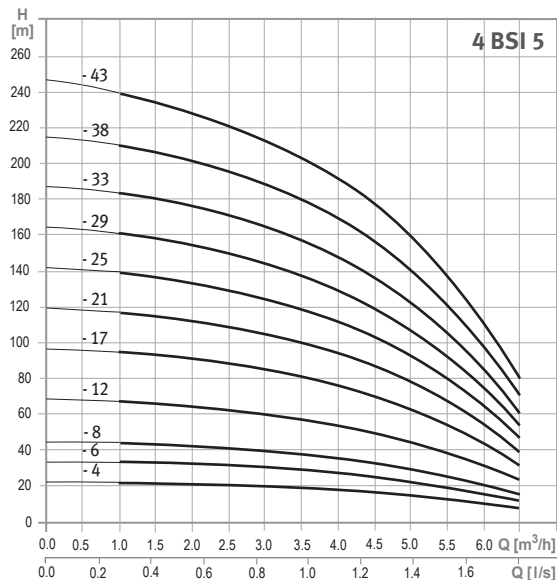
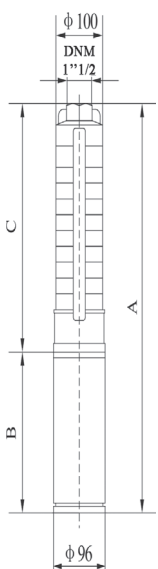

MODELO   MODEL		POTÊNCIA POWER (kW)	DIMENSÕES   DIMENSIONS (mm)			PESO WEIGHT (kg)
1 ~	3 ~		A	B	C	
4BSI M5-4	4BSI 5-4	0,37	625	370	255	12
4BSI M5-6	4BSI 5-6	0,55	677	380	297	13
4BSI M5-8	4BSI 5-8	0,75	739	400	339	15
4BSI M5-12	4BSI 5-12	1,1	863	440	423	17
4BSI M5-17	4BSI 5-17	1,5	998	470	528	21
4BSI M5-21	4BSI 5-21	2,2	1112	510	612	26
4BSI M5-25	4BSI 5-25	2,2	1206	510	696	27
-	4BSI 5-29	3,0	1400	620	780	29
-	4BSI 5-33	3,0	1484	620	864	30
-	4BSI 5-38	4,0	1719	750	969	33
-	4BSI 5-43	4,0	1824	750	1074	35

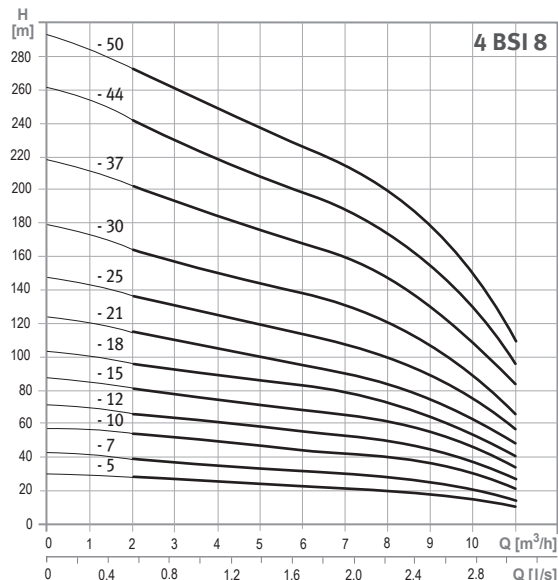
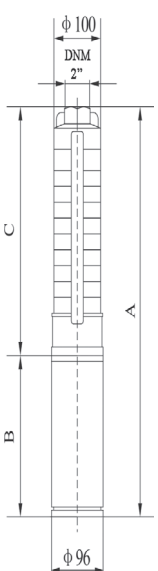

MODELO   MODEL		POTÊNCIA POWER (kW)	DIMENSÕES   DIMENSIONS (mm)			PESO WEIGHT (kg)
1 ~	3 ~		A	B	C	
4BSI M8-5	4BSI 8-5	0,75	853	400	453	16
4BSI M8-7	4BSI 8-7	1,1	977	440	537	19
-	4BSI 8-10	1,5	1133	470	663	22
-	4BSI 8-12	2,2	1257	510	747	27
-	4BSI 8-15	2,2	1383	510	873	29
-	4BSI 8-18	3,0	1619	620	999	32
-	4BSI 8-21	4,0	1875	750	1125	35
-	4BSI 8-25	4,0	2043	750	1293	37
-	4BSI 8-30	5,5	2343	840	1503	43
-	4BSI 8-37	5,5	2637	840	1797	46
-	4BSI 8-44	7,5	3011	920	2091	55
-	4BSI 8-50	7,5	3263	920	2343	58

## BSI Bombas Subterrâneas de Furo | Submersible Well Pumps

MODELO MODEL 3 ~	POTÊNCIA POWER (kW)	DIMENSÕES   DIMENSIONS (mm)			PESO WEIGHT (Kg)
		A	B	C	
4BSI 12-5	1,5	1005	470	535	21
4BSI 12-7	2,2	1175	510	665	26
4BSI 12-10	3,0	1480	620	860	30
4BSI 12-13	4,0	1805	750	1055	34
4BSI 12-15	5,5	2025	840	1185	38
4BSI 12-18	5,5	2220	840	1380	40
4BSI 12-21	7,5	2495	920	1575	47
4BSI 12-25	7,5	2755	920	1835	50

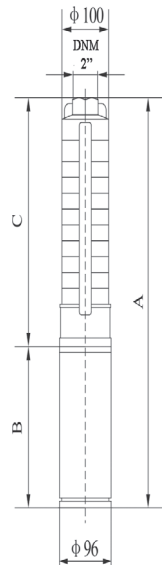
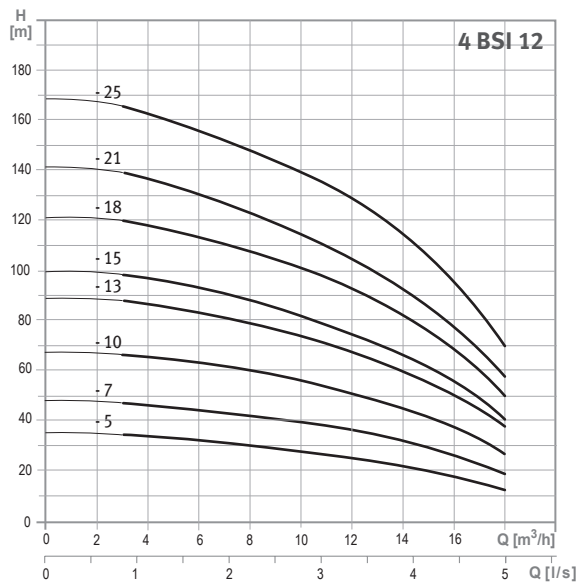

MODELO MODEL 3 ~	POTÊNCIA POWER (kW)	DIMENSÕES   DIMENSIONS (mm)				PESO WEIGHT (Kg)
		A	B	C	ØD	
6BSI 17-1 /4*	0,55	708	380	328	96	17
6BSI 17-2 /4*	1,1	828	440	388	96	21
6BSI 17-3 /4*	2,2	959	510	449	96	28
6BSI 17-4 /4*	2,2	1059	510	509	96	29
6BSI 17-5 /4*	3,0	1190	620	570	96	32
6BSI 17-6 /4*	4,0	1380	750	630	96/143	35/41
6BSI 17-7 /4*	4,0	1441	750	691	96/143	36/42
6BSI 17-8 /4*	5,5	1591	840	751	96/143	41/49
6BSI 17-9 /4*	5,5	1652	840	812	96/143	42/50
6BSI 17-10 /4*	5,5	1712	840	872	96/143	43/51
6BSI 17-11 /4*	7,5	1853	920	933	96/143	49/60
6BSI 17-12 /4*	7,5	1913	920	993	96/143	50/61
6BSI 17-13 /4*	7,5	1974	920	1054	96/143	51/62
6BSI 17-14	9,2	200	870	1130	143	75
6BSI 17-15	9,2	2061	870	1191	143	76
6BSI 17-16	9,2	2121	870	1251	143	77
6BSI 17-17	9,2	2182	870	1312	143	78
6BSI 17-18	11	2292	920	1372	143	85
6BSI 17-19	11	2353	920	1433	143	86
6BSI 17-20	11	2413	920	1493	143	87
6BSI 17-21	13	2534	980	1554	143	95
6BSI 17-22	13	2594	980	1614	143	96
6BSI 17-23	13	2655	980	1675	143	98
6BSI 17-24	13	2715	980	1735	143	99
6BSI 17-25	15	2826	1030	1796	143	106
6BSI 17-26	15	2886	1030	1856	143	107

\* Bombas de 6" acopladas a motor de 4" | 6" pumps coupled to a 4" motor

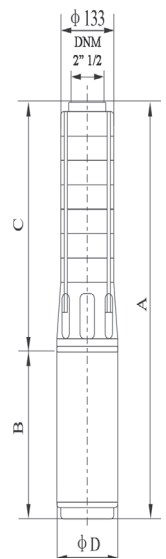
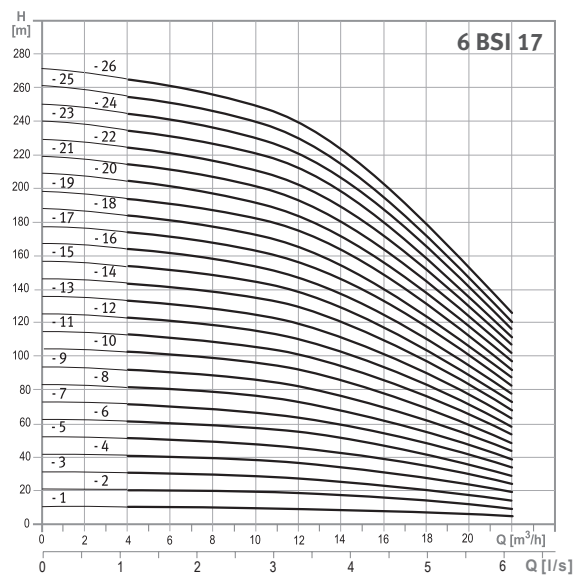

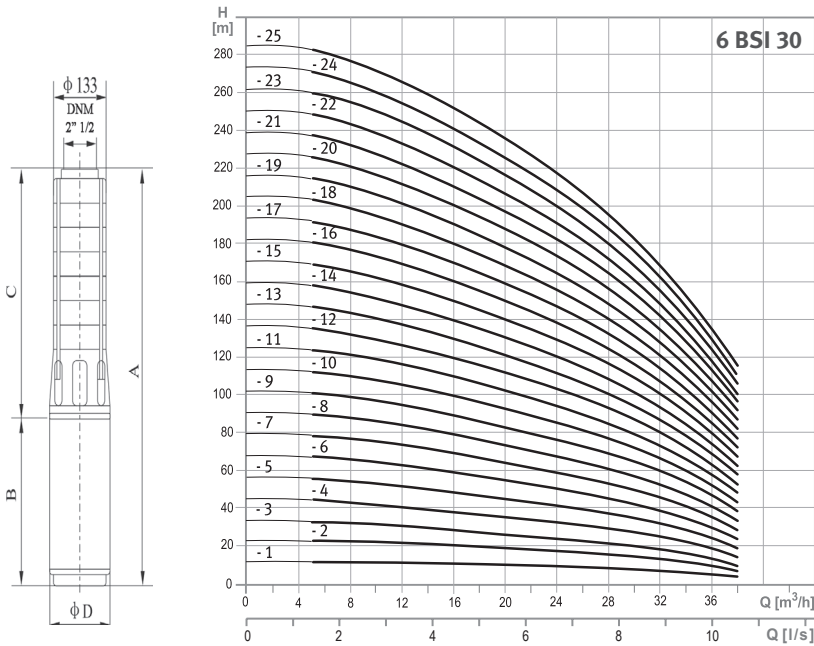

MODELO MODEL 3 ~	POTÊNCIA POWER (kW)	DIMENSÕES   DIMENSIONS (mm)				PESO WEIGHT (Kg)
		A	B	C	ØD	
6BSI 30-1 /4*	1.1	802	440	362	96	20
6BSI 30-2 /4*	2.2	968	510	458	96	28
6BSI 30-3 /4*	3.0	1174	620	554	96	31
6BSI 30-4 /4*	4.0	1400	750	650	96/143	35/41
6BSI 30-5 /4*	5.5	1586	840	746	96/143	40/48
6BSI 30-6 /4*	5.5	1682	840	842	96/143	42/45
6BSI 30-7 /4*	7.5	1858	920	938	96/143	49/60
4BSI 30-8 /4*	7.5	1954	920	1034	96/143	51/61
6BSI 30-9	9.2	2016	870	1146	143	75
6BSI 30-10	9.2	2112	870	1242	143	77
6BSI 30-11	9.2	2208	870	1338	143	79
6BSI 30-12	11	2354	920	1434	143	85
6BSI 30-13	11	2450	920	1530	143	87
6BSI 30-14	13	2606	980	1626	143	96
6BSI 30-15	13	2702	980	1722	143	98
6BSI 30-16	15	2848	1030	1818	143	106
6BSI 30-17	15	2944	1030	1914	143	108
6BSI 30-18	18.5	3100	1090	2010	143	117
6BSI 30-19	18.5	3196	1090	2106	143	119
6BSI 30-20	18.5	3292	1090	2202	143	120
6BSI 30-21	18.5	3388	1090	2298	143	122
6BSI 30-22	22	3554	1160	2394	143	138
6BSI 30-23	22	3650	1160	2490	143	140
6BSI 30-24	22	3746	1160	2586	143	142
6BSI 30-25	22	3842	1160	2682	143	144

\* Bombas de 6" acopladas a motor de 4" | 6" pumps coupled to a 4" motor

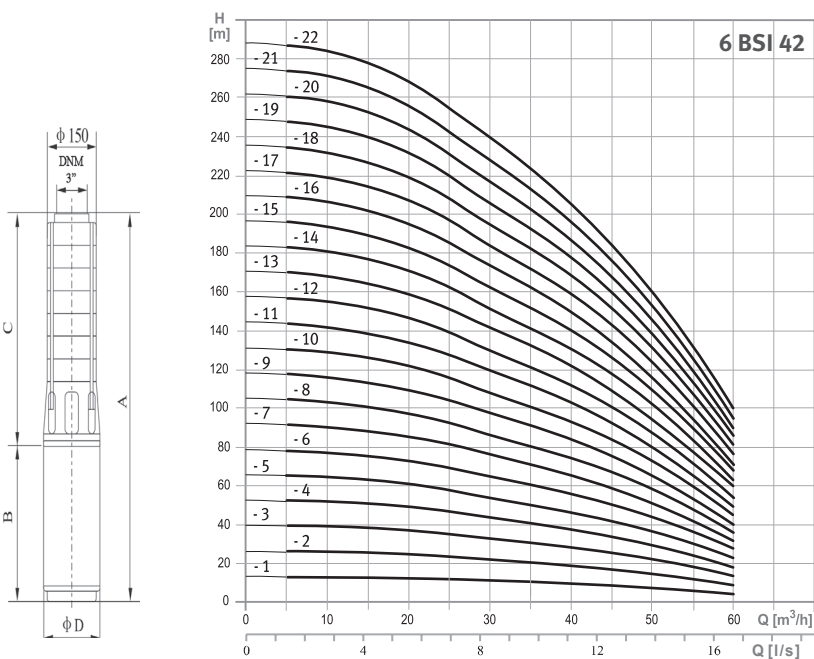

MODELO MODEL 3 ~	POTÊNCIA POWER (kW)	DIMENSÕES   DIMENSIONS (mm)				PESO WEIGHT (Kg)
		A	B	C	ØD	
6BSI 42-1 /4*	2.2	888	510	378	96	29
6BSI 42-2 /4*	3.0	1111	620	491	96	33
6BSI 42-3 /4*	5.5	1444	840	604	96/143	40/48
6BSI 42-4 /4*	7.5	1637	920	717	96/143	47/58
6BSI 42-5 /4*	7.5	1750	920	830	96/143	49/60
6BSI 42-6	9.2	1829	870	959	143	73
6BSI 42-7	11	1992	920	1072	143	80
6BSI 42-8	13	2165	980	1185	143	89
6BSI 42-9	15	2328	1030	1298	143	97
6BSI 42-10	15	2441	1030	1411	143	100
6BSI 42-11	18.5	2614	1090	1524	143	109
6BSI 42-12	18.5	2727	1090	1637	143	111
6BSI 42-13	22	2910	1160	1750	143	127
6BSI 42-14	22	3023	1160	1863	143	129
6BSI 42-15	22	3136	1160	1976	143	131
6BSI 42-16	26	3319	1230	2089	143	145
6BSI 42-17	26	3432	1230	2202	143	147
6BSI 42-18	30	3645	1330	2315	143	162
6BSI 42-19	30	3758	1330	2428	143	164
6BSI 42-20	30	3871	1330	2541	143	167
6BSI 42-21	37	4224	1570	2654	143	192
6BSI 42-22	37	4337	1570	2767	143	194

\* Bombas de 6" acopladas a motor de 4" | 6" pumps coupled to a 4" motor

## BSI Bombas Subterrâneas de Furo | Submersible Well Pumps

MODELO MODEL 3 ~	POTÊNCIA POWER (kW)	DIMENSÕES   DIMENSIONS (mm)				PESO WEIGHT (Kg)
		A	B	C	ØD	
6BSI 60-1 /4*	2.2	878	510	368	96	30
6BSI 60-2-2 /4*	3.0	1101	620	481	96	33
6BSI 60-2 /4*	4.0	1231	750	481	96/143	35/41
6BSI 60-3 /4*	5.5	1434	840	594	96/143	41/49
6BSI 60-4 /4*	7.5	1627	920	707	96/143	48/59
6BSI 60-5	9.2	1690	870	820	143	72
6BSI 60-6	11	1869	920	949	143	78
6BSI 60-7	13	2042	980	1062	143	87
6BSI 60-8-2	13	2155	980	1175	143	88
6BSI 60-8	15	2205	1030	1175	143	96
6BSI 60-9-2	15	2318	1030	1288	143	97
6BSI 60-9	18.5	2378	1090	1288	143	105
6BSI 60-10	18.5	2491	1090	1401	143	107
6BSI 60-11	22	2674	1160	1514	143	123
6BSI 60-12	22	2787	1160	1627	143	125
6BSI 60-13	22	2900	1160	1740	143	127
6BSI 60-14	25	3083	1230	1853	143	141
6BSI 60-15	25	3196	1230	1966	143	143
6BSI 60-16	30	3409	1330	2079	143	158
6BSI 60-17	30	3522	1330	2192	143	160
6BSI 60-18	30	3635	1330	2305	143	162
6BSI 60-19	37	3988	1570	2418	143	188
6BSI 60-20	37	4101	1570	2531	143	190
6BSI 60-21	37	4214	1570	2644	143	191

\* Bombas de 6" acopladas a motor de 4" | 6" pumps coupled to a 4" motor

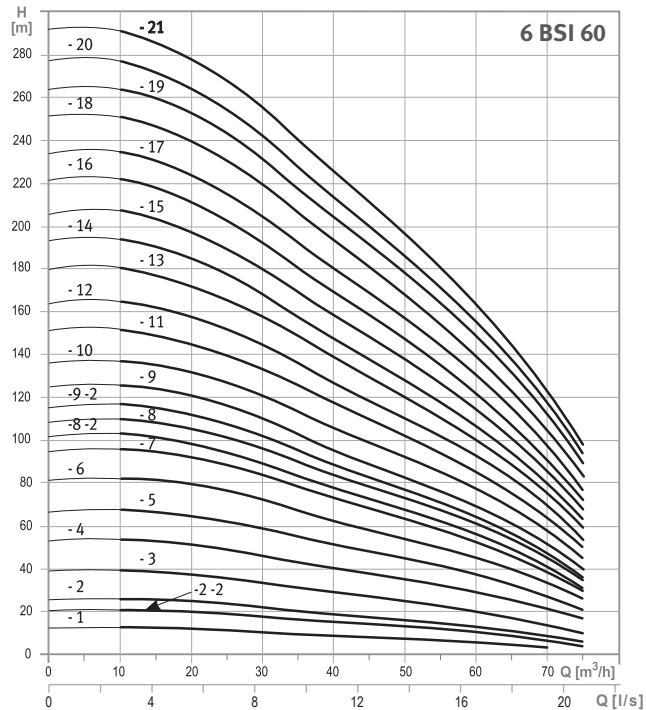

MODELO MODEL 3 ~	POTÊNCIA POWER (kW)	DIMENSÕES   DIMENSIONS (mm)				PESO WEIGHT (Kg)
		A	B	C	ØD	
8BSI 75-1 /6*	4	1268	780	488	143	56
8BSI 75-2 /6*	7,5	1424 1411	810 780	614 631	143 184	78 97
8BSI 75-3 /6*	11	1660 1577	920 820	740 757	143 184	92 116
8BSI 75-4 /6*	15	1896 1743	1030 860	866 883	143 184	110 134
8BSI 75-5 /6*	18,5	2082 1899	1090 890	992 1009	143 184	122 152
8BSI 75-6 /6*	22	2278 2075	1160 940	1118 1135	143 184	141 178
8BSI 75-7 /6*	30	2574 2311	1330 1050	1244 1261	143 184	171 211
8BSI 75-8 /6*	30	2700 2437	1330 1050	1370 1387	143 184	176 216
8BSI 75-9 /6*	37	3066 2663	1570 1150	1496 1513	143 184	204 233
8BSI 75-10 /6*	37	3192 2789	1570 1150	1622 1639	143 184	209 238
8BSI 75-11	45	3005	1240	1765	184	256
8BSI 75-12	45	3131	1240	1891	184	261
8BSI 75-13	55	3387	1370	2017	184	279
8BSI 75-14	55	3513	1370	2143	184	285
8BSI 75-15	55	3639	1370	2269	184	290
8BSI 75-16	63	3885	1490	2395	192	309
8BSI 75-17	63	4011	1490	2521	192	315
8BSI 75-18	75	4187	1540	2647	192	341
8BSI 75-19	75	4313	1540	2773	192	346
8BSI 75-20	75	4439	1540	2899	192	351

\* Bombas de 8" acopladas a motor de 6" | 8" pumps coupled to a 6" motor

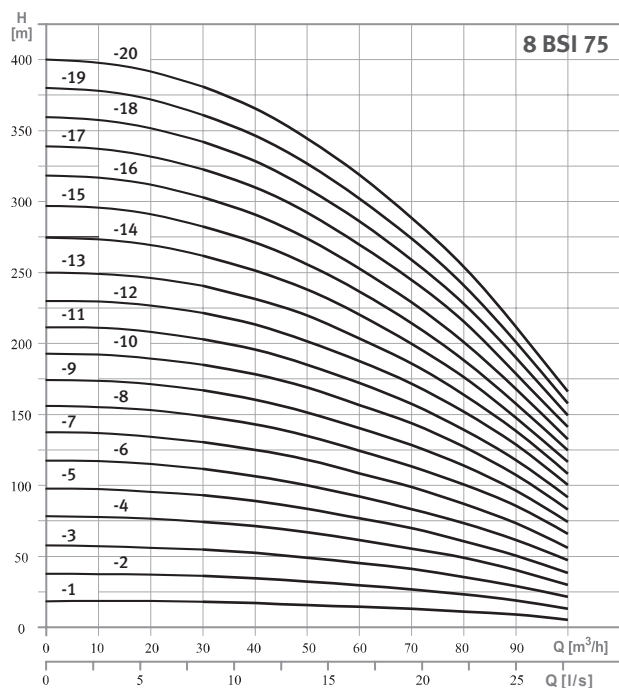

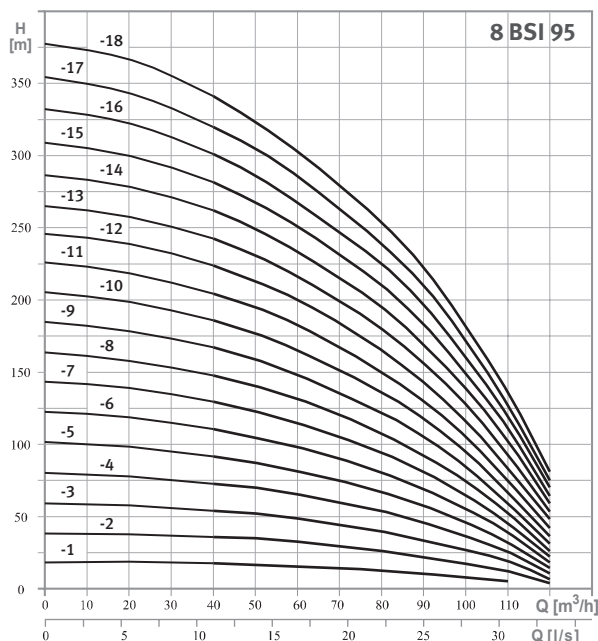
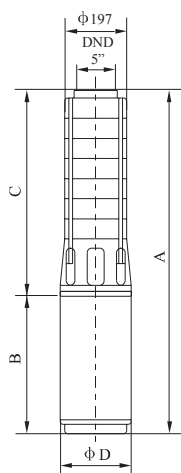

MODELO MODEL 3 ~	POTÊNCIA POWER (kW)	DIMENSÕES   DIMENSIONS (mm)				PESO WEIGHT (kg)
		A	B	C	ØD	
8BSI 95-2/6*	9,2	1484 1431	870 800	614 631	143 184	83 105
8BSI 95-3/6*	13	1720 1617	980 860	740 757	143 184	100 129
8BSI 95-4/6*	18,5	1956 1773	1090 890	866 883	143 184	119 148
8BSI 95-5/6*	22	2152 1949	1160 940	992 1009	143 184	138 175
8BSI 95-6/6*	25	2348 2125	1230 990	1118 1135	143 184	155 188
8BSI 95-7/6*	30	2574 2311	1330 1050	1244 1261	143 184	174 213
8BSI 95-8/6*	37	2940 2537	1570 1150	1370 1387	143 184	202 231
8BSI 95-9/6*	37	3066 2663	1570 1150	1496 1513	143 184	208 237
8BSI 95-10	45	2879	1240	1639	184	254
8BSI 95-11	45	3005	1240	1765	184	260
8BSI 95-12	55	3261	1370	1891	184	279
8BSI 95-13	55	3387	1370	2017	184	284
8BSI 95-14	55	3513	1370	2143	184	290
8BSI 95-15	63	3759	1490	2269	192	310
8BSI 95-16	63	3885	1490	2395	192	316
8BSI 95-17	75	4061	1540	2521	192	342
8BSI 95-18	75	4187	1540	2647	192	348

\* Bombas de 8" acopladas a motor de 6" | 8" pumps coupled to a 6" motor

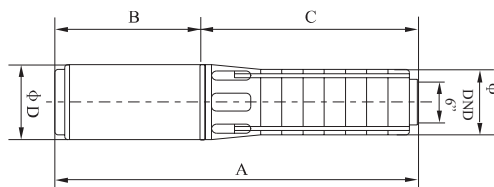
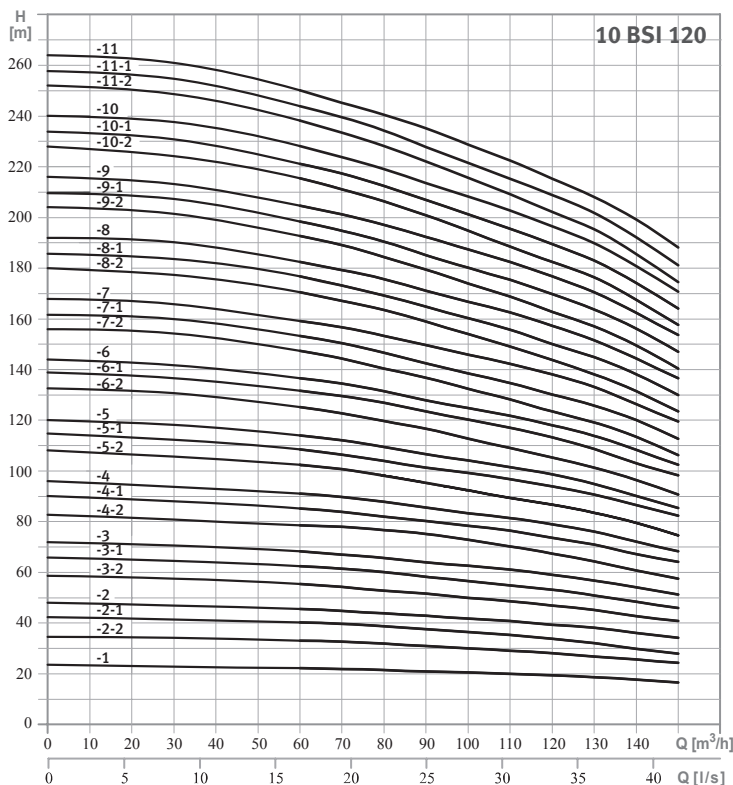

MODELO MODEL 3 ~	POTÊNCIA POWER (kW)	DIMENSÕES   DIMENSIONS (mm)				PESO WEIGHT (kg)
		A	B	C	ØD	
10BSI 120-1	11	1380	820	560	184	121
10BSI 120-2-2	15	1580	860	720	184	135
10BSI 120-2-1	18,5	1610	890	720	184	140
10BSI 120-2	22	1660	940	720	184	155
10BSI 120-3-2	25	1870	990	880	184	173
10BSI 120-3-1	30	1930	1050	880	184	187
10BSI 120-3	30	1930	1050	880	184	187
10BSI 120-4-2	37	2190	1150	1040	184	210
10BSI 120-4-1	37	2190	1150	1040	184	210
10BSI 120-4	37	2190	1150	1040	184	210
10BSI 120-5-2	45	2440	1240	1200	184	233
10BSI 120-5-1	45	2440	1240	1200	184	233
10BSI 120-5	55	2570	1370	1200	184	253
10BSI 120-6-2	55	2730	1370	1360	184	261
10BSI 120-6-1	55	2730	1370	1360	184	261
10BSI 120-6	63	2850	1490	1360	192	288
10BSI 120-7-2	63	3010	1490	1520	192	296
10BSI 120-7-1	63	3010	1490	1520	192	296
10BSI 120-7	75	3060	1540	1520	192	306
10BSI 120-8-2	75	3220	1540	1680	192	314
10BSI 120-8-1	75	3220	1540	1680	192	314
10BSI 120-8	75	3220	1540	1680	192	314
10BSI 120-9-2	90	3484	1644	1840	192	342
10BSI 120-9-1	90	3484	1644	1840	192	342
10BSI 120-9	90	3484	1644	1840	192	342
10BSI 120-10-2	90	3644	1644	2000	192	350
10BSI 120-10-1	90	3644	1644	2000	192	350
10BSI 120-10	110	3764	1764	2000	192	376
10BSI 120-11-2	110	3924	1764	2160	192	384
10BSI 120-11-1	110	3924	1764	2160	192	384
10BSI 120-11	110	3924	1764	2160	192	384

## BSI Bombas Subterrâneas de Furo | Submersible Well Pumps

MODELO MODEL 3 -	POTÊNCIA POWER (kW)	DIMENSÕES   DIMENSIONS (mm)				PESO WEIGHT (Kg)
		A	B	C	ØD	
10BSI 150-1-1	9.2	1401 / 1360 / --	870 / 800 / --	531 / 560 / --	144 / 148 / --	92 / 117 / --
10BSI 150-1	13	1561 / 1420 / --	1030 / 860 / --	531 / 560 / --	144 / 148 / --	100 / 124 / --
10BSI 150-2-2	18.5	1781 / 1610 / --	1090 / 890 / --	691 / 720 / --	144 / 148 / --	119 / 141 / --
10BSI 150-2-1	22	1851 / 1660 / --	1160 / 940 / --	691 / 720 / --	144 / 148 / --	128 / 156 / --
10BSI 150-2	25	1921 / 1710 / --	1230 / 990 / --	691 / 720 / --	144 / 148 / --	135 / 166 / --
10BSI 150-3-2	30	2181 / 1930 / 2042	1330 / 1050 / 1162	851 / 880 / 880	144 / 184 / 236	149 / 188 / 228
10BSI 150-3-1	37	2421 / 2030 / 2042	1570 / 1150 / 1162	851 / 880 / 880	144 / 184 / 236	158 / 202 / 246
10BSI 150-3	37	2421 / 2030 / 2042	1570 / 1150 / 1162	851 / 880 / 880	144 / 184 / 236	158 / 202 / 246
10BSI 150-4-2	45	-- / 2280 / 2232	-- / 1240 / 1192	-- / 1040 / 1040	-- / 184 / 236	-- / 225 / 274
10BSI 150-4-1	45	-- / 2280 / 2232	-- / 1240 / 1192	-- / 1040 / 1040	-- / 184 / 236	-- / 225 / 274
10BSI 150-4	55	-- / 2410 / 2312	-- / 1370 / 1272	-- / 1040 / 1040	-- / 184 / 236	-- / 245 / 307
10BSI 150-5-2	55	-- / 2570 / 2472	-- / 1370 / 1272	-- / 1200 / 1200	-- / 184 / 236	-- / 253 / 315
10BSI 150-5-1	55	-- / 2570 / 2472	-- / 1370 / 1272	-- / 1200 / 1200	-- / 192 / 236	-- / 253 / 315
10BSI 150-5	63	-- / 2690 / 2532	-- / 1490 / 1332	-- / 1200 / 1200	-- / 192 / 236	-- / 280 / 333
10BSI 150-6-2	63	-- / 2850 / 2692	-- / 1490 / 1332	-- / 1360 / 1360	-- / 192 / 236	-- / 288 / 341
10BSI 150-6-1	75	-- / 2900 / 2782	-- / 1540 / 1422	-- / 1360 / 1360	-- / 192 / 236	-- / 298 / 379
10BSI 150-6	75	-- / 2900 / 2782	-- / 1540 / 1422	-- / 1360 / 1360	-- / 192 / 236	-- / 298 / 379
10BSI 150-7-2	75	-- / 3060 / 2942	-- / 1540 / 1422	-- / 1520 / 1520	-- / 192 / 236	-- / 306 / 387
10BSI 150-7-1	90	-- / 3164 / 3051	-- / 1644 / 1531	-- / 1520 / 1520	-- / 192 / 236	-- / 326 / 400
10BSI 150-7	90	-- / 3164 / 3051	-- / 1644 / 1531	-- / 1520 / 1520	-- / 192 / 236	-- / 326 / 400
10BSI 150-8-2	90	-- / 3324 / 3211	-- / 1644 / 1531	-- / 1680 / 1680	-- / 192 / 236	-- / 334 / 408
10BSI 150-8-1	110	-- / 3444 / 3321	-- / 1764 / 1641	-- / 1680 / 1680	-- / 192 / 236	-- / 360 / 426
10BSI 150-8	110	-- / 3444 / 3321	-- / 1764 / 1641	-- / 1680 / 1680	-- / 192 / 236	-- / 360 / 426
10BSI 150-9-2	110	-- / 3604 / 3481	-- / 1764 / 1641	-- / 1840 / 1840	-- / 192 / 236	-- / 369 / 435
10BSI 150-9-1	110	-- / 3604 / 3481	-- / 1764 / 1641	-- / 1840 / 1840	-- / 192 / 236	-- / 369 / 435
10BSI 150-9	110	-- / 3604 / 3481	-- / 1764 / 1641	-- / 1840 / 1840	-- / 192 / 236	-- / 369 / 435

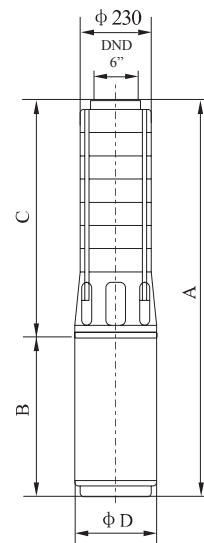
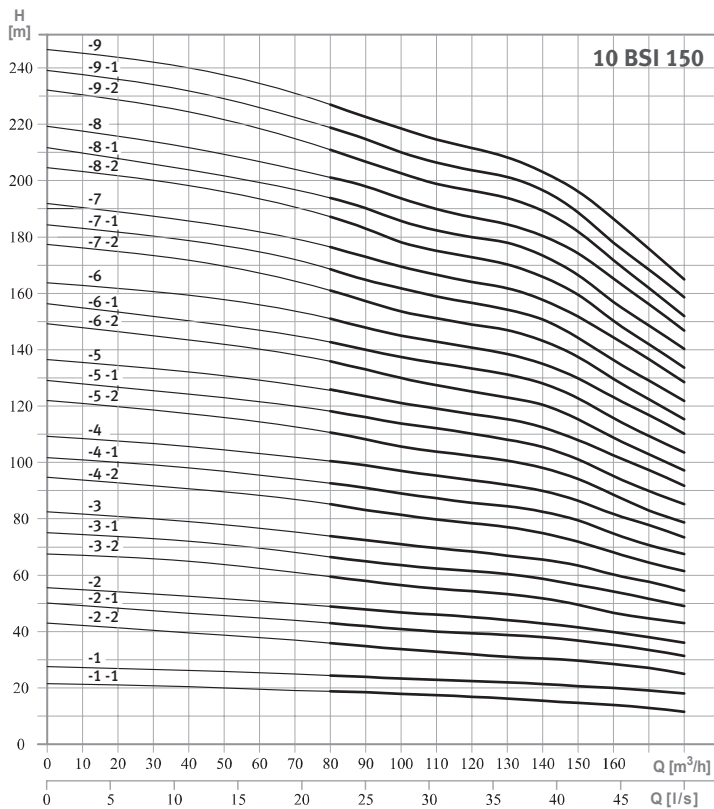

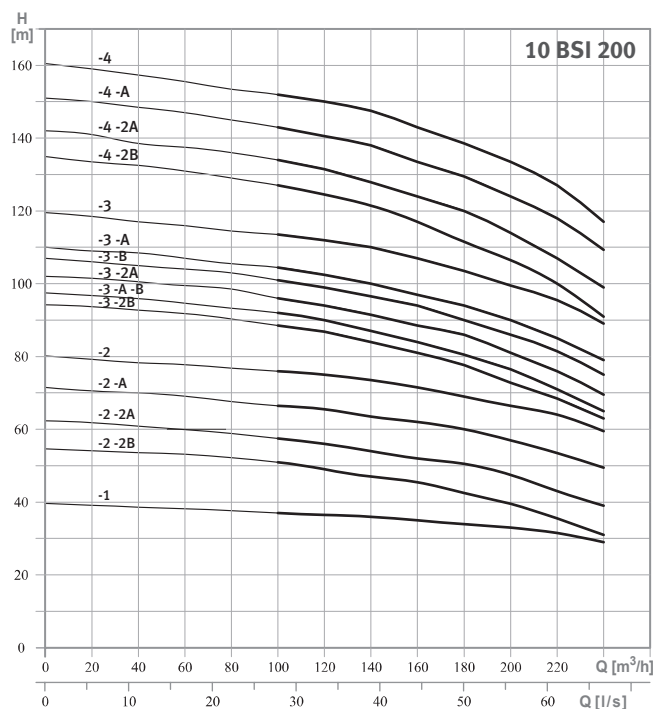

MODELO MODEL 3 ~	POTÊNCIA POWER (kW)	DIMENSÕES   DIMENSIONS (mm)				PESO WEIGHT (kg)
		A	B	C	ØD	
10BSI 200-1	30	1721	1122	599	236	221
10BSI 200-2-2B	37	1955	1162	793	236	255
10BSI 200-2-2A	45	1985	1192	793	236	275
10BSI 200-2-A	55	2065	1272	793	236	308
10BSI 200-2	55	2065	1272	793	236	308
10BSI 200-3-2B	75	2409	1422	987	236	386
10BSI 200-3-A-B	75	2409	1422	987	236	386
10BSI 200-3-2A	75	2409	1422	987	236	386
10BSI 200-3-B	75	2409	1422	987	236	386
10BSI 200-3-A	75	2409	1422	987	236	386
10BSI 200-3	90	2519	1532	987	236	399
10BSI 200-4-2B	90	2713	1532	1181	236	416
10BSI 200-4-2A	110	2823	1642	1181	236	453
10BSI 200-4-A	110	2823	1642	1181	236	453
10BSI 200-4	110	2823	1642	1181	236	453

